

**FH-KB/AL**

Flat Head Knurled Body Aluminium

Silindir Flaş Kafa Alüminyum

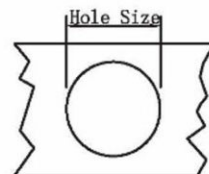
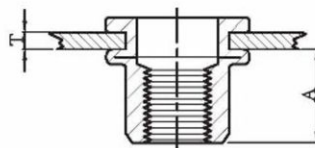
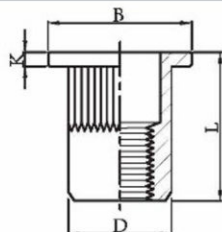

UNIT : mm

Thread	P/N	T(GRIP RANGE) Min Max	A Rer	Hole Size $+0.1$	D $+0.07$ $-0.1$	B	K	L
M4	FH-KB/AL-0420	0.5-2.0	6.0	6.0	5.9	8.8*	0.8*	10.5*
M5	FH-KB/AL-0525	0.5-2.5	7.5	7.0	6.9	10.0	1.0	13.0
M6	FH-KB/AL-0625	0.5-2.5	9.2	9.0	8.9	12.3	1.5	15.0
M8	FH-KB/AL-0830	1.0-3.0	10.2	11.0	10.9	14.3	1.5	16.5
M10	FH-KB/AL-1040	1.0-4.0	11.5	13.0	12.9	16.3	1.6	19.0

**RH-KB/AL**

Reduce Head Knurled Body Aluminium

Silindir Sıfır Kafa Alüminyum

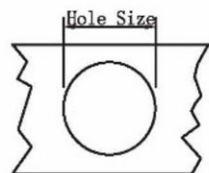
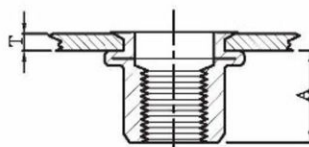
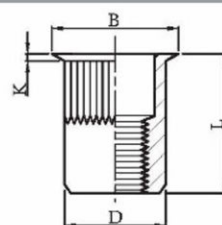

UNIT : mm

Thread	P/N	T(GRIP RANGE) Min Max	A Rer	Hole Size $+0.1$	D $+0.07$ $-0.1$	B	K	L
M4	RH-KB/AL-0420	0.5-2.0	6.0	6.0	5.9	7.0	0.5	10.5
M5	RH-KB/AL-0520	0.5-2.0	7.5	7.0	6.9	8.0	0.5	11.5
M6	RH-KB/AL-0625	0.5-2.5	9.2	9.0	8.9	10.0	0.6*	14.0*
M8	RH-KB/AL-0825	0.5-2.5	10.2	11.0	10.9	12.0	0.65*	15.5*
M10	RH-KB/AL-1030	1.0-3.0	11.5	13.0	12.9	14.1	0.7*	17.7*