

## KF2

## SELF CLINCHING NUTS

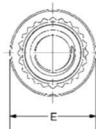

## Part Number Designation

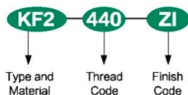

All dimensions are in inches (Size Unit: inch)

	Thread Size X Pitch	Type		Thread Code	A Max.	Min. Sheet Thickness	Hole size in Sheet +0.03 -0.00	C ± .003	E ± .005	T ± .005	Min. Dist Hole C/L To Edge
		Carbon Steel	Stainless Steel								
UNIFIED	.086-56(#2-56)	KF2	KFS2	256	.06	.06	.147	.165	.219	.065	.16
	.112-40(#4-40)	KF2	KFS2	440	.06	.06	.166	.184	.219	.065	.17
	.138-32(#6-32)	KF2	KFS2	632	.06	.06	.213	.231	.281	.065	.22
	.164-32(#8-32)	KF2	KFS2	832	.06	.06	.250	.268	.344	.096	.25
	.190-32(#10-32)	KF2	KFS2	032	.06	.06	.272	.290	.375	.127	.28

All dimensions are in millimeters (Size Unit: mm)

	Thread Size X Pitch	Type		Thread Code	A Max.	Min. Sheet Thickness	Hole size in Sheet +0.08	C ± 0.08	E ± 0.13	T ± 0.13	Min. Dist Hole C/L To Edge
		Carbon Steel	Stainless Steel								
METRIC	M2X0.4	KF2	KFS2	M2	1.53	1.53	3.73	4.19	5.56	1.5	4.2
	M2.5X0.45	KF2	KFS2	M2.5	1.53	1.53	4.22	4.68	5.56	1.5	4.4
	M3X0.5	KF2	KFS2	M3	1.53	1.53	4.22	4.68	5.56	1.5	4.4
	M4X0.7	KF2	KFS2	M4	1.53	1.53	6.4	6.86	8.74	2	6.4
	M5X0.8	KF2	KFS2	M5	1.53	1.53	6.9	7.37	9.53	3	7.1