

## KSSB

## KEYHOLE STANDOFFS

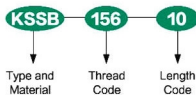

## Part Number Designation



KSSB: Free Machining Brass

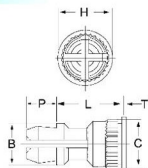

All dimensions are in inches(Size Unit:inch)

UNIFIED	Type	Top Panel Mounting Hole Diameter Code	Length "L" ± .005 (Length Code in 32ths of an Inch)										B	C	H	P	T
	Free Machining Brass		.250	.312	.375	.437	.500	.562	.625	.750	.875	1.00	±.005	±.003	±.005	±.005	±.005
	KSSB	156	8	10	12	14	16	18	20	24	28	32	.188	.226	.250	.141	.020

All dimensions are in millimeters(Size Unit:mm)

METRIC	Type	Top Panel Mounting Hole Diameter Code 250	Length Code "L" ± 0.13 (Length Code in millimeters)										B	C	H	P	T
	Free Machining Brass		8	10	12	14	16	18	20	22	25	±0.13	±0.08	±0.13	±0.13	±0.13	
	KSSB	156	8	10	12	14	16	18	20	22	25	4.78	5.74	6.35	3.58	0.51	